



Let's make things better.



PHILIPS



TABLE OF CONTENTS

Introduction

Safety Information/Useful Tips	3
Before Calling Service	4

Basic Installation/Function

Hooking Up Your TV (Basic Connection)	5
Use/Care of Remote Control	5
Connecting the Audio/Video Sockets (Playback)	6
Functions of Remote Control	7
Functions of TV Controls	8

TV Installation

Selecting the Main Menu	9
Automatic Tuning of Channels	10
Manual Tuning of Channels	10
Fine Tuning of Channels	12
Selecting the Colour/Sound System	13
Adjusting the TV Picture	14
Smart Picture Control	15

General

Specification	16
---------------------	----



Recycling Directive – To minimise harm to the environment, the batteries supplied with the TV set do not contain mercury or nickel cadmium. If possible, when disposing of batteries, use recycling means available to you. Your TV set uses materials which are reusable or which can be recycled. To minimise the amount of waste in the environment, specialist companies recover used sets for dismantling and collection of reusable materials (contact your dealer).



SAFETY INFORMATION AND USEFUL TIPS

Safety Information

- Disconnect mains plug when:
 - the red light below the TV screen is flashing continuously.
 - a bright white line is displayed across the screen.
 - cleaning the TV screen. Never use abrasive cleaning agents. Use a slight damp chamois leather or soft cloth.
 - there is a lightning storm.
 - the set is left unattended for a prolonged period of time.
- No naked flame sources, such as lighted candles, should be placed on top of the TV or in the vicinity.
- Do not place your TV set under direct sunlight or heat.
- Leave at least 5 cm around each side of TV set to allow for proper ventilation.
- Avoid placing your set (e.g. near the window) where it is likely to be exposed to rain or water.
- No objects filled with liquids should be placed on top the TV so as to avoid dripping or splashing of liquids on the set.

Useful Tips

- Do not leave your set on standby mode for a prolonged period of time. Switch off set to allow it to be demagnetised. A demagnetised set supports good picture quality.
- Do not shift or move the set around when it is switched on. Unevenness in colour in some parts of the screen may occur.
- Never attempt to repair a defective TV yourself. Always consult a skilled service personnel.



BEFORE CALLING SERVICE

Below is a list of frequently occurred symptoms. Before you call for service, make these simple checks. Some of these symptoms can easily be rectified if you know what to do.

Symptom

What you should do

Colour patch
(unevenness)

- Switch off the TV by the mains power button. Wait for 20 minutes before switching on again.
- Check the TV is not placed too near speakers or magnetic objects.

No power

- Check the TV's AC power cord is plugged into the mains socket. If there is still no power, disconnect plug. Wait for 60 seconds and re-insert plug. Switch on TV again.

No picture

- Check the antenna connection at the rear of the TV.
- Possible TV station problem. Try another channel.

Good picture
but no sound

- Try increasing the volume.
- Check that the sound is not muted. If it is muted, press the Mute button on the remote control to restore sound.

Good sound but poor
colour or no picture

- Try increasing the contrast colour and brightness setting.

Snowish picture and
noise

- Check antenna connection at the rear of the TV.

Horizontal dotted lines

- Possible electrical interference e.g. hairdryer, vacuum cleaner, etc. Switch off appliances.

Double images or
"Ghost" images

- Possible poor positioning of antenna. Using a highly directional antenna may improve reception.

TV not responding to
remote control handset

- Check life span of batteries of remote control handset.
- Aim remote control handset directly at remote control sensor lens on the TV.



HOOKING UP YOUR TV (BASIC CONNECTION)

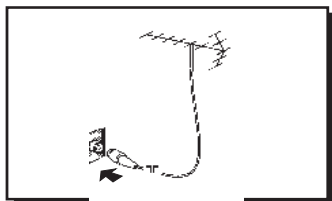

Antenna Connection

- Connect the aerial plug to the antenna socket  on the backcover.

- Insert the mains plug into the wall socket.

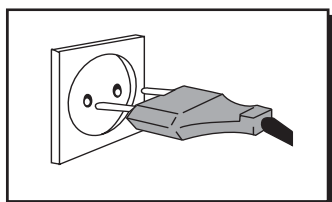

Mains Connection

- For correct mains voltage, refer to type sticker at the rear of the TV set.

- Consult your dealer if mains supply is different.

Note : This diagram is not representative of the actual plug and socket.

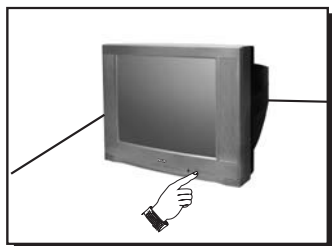

Switch on the set

- Press the main power button to switch on/off the TV.

- If the set is on standby (indicator is red), press the Power button on the remote control to switch on set.

USE/CARE OF REMOTE CONTROL

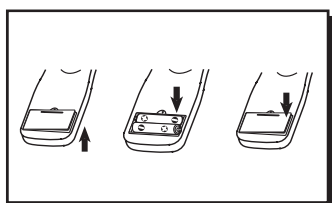

- Insert the correct type of batteries into the compartment.

- Ensure the batteries are placed in the right direction.



- For S-VIDEO IN and VIDEO 1 IN share the same channel, therefore can not be used simultaneously.
- S-VIDEO offers superior colour and detail reproduction over conventional video connections.



FUNCTION of REMOTE CONTROL

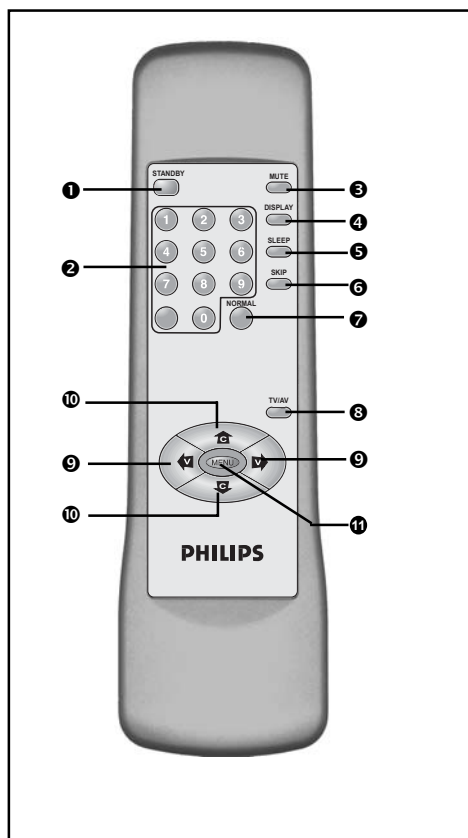

❶ Standby button

- Switch the set off temporarily to standby mode. (The red light indicator lights up when the set is on standby mode).
- To switch on set from standby mode, press Channel +/- , or TV/AV, Standby button.

❷ Digit (0-9) / -/-- Buttons

- Press 0-9 buttons to select a channel. For a 2-digit channel number, press -/-- button follow by the required digits.

❸ Mute Buttons

- Mute sound. To restore sound, press button again.

❹ Display Button

- Press to display the current channel NO. , colour and sound system.

❺ Sleep Button

Allows you to select a time period after which the set will switch to standby mode automatically. This television can be programmed up to 120 minutes (10 minutes intervals).

❻ Skip Button

Select an unwanted channel NO., press button to skip. The channel number will be displayed in red. **Note:** To restore the skipped channel, press digit button or -/-- button to recall the skipped channel NO., then press Skip button to change the channel NO. from red to green colour.

❼ Normal Button

To switch between the 4 picture settings: DYNAMIC, STANDARD, MILD and MEMORY.

❽ TV/AV Button

To switch between TV channel and AV input sources.

❾ Volume +/- Buttons

- Increases or decreases volume.
- Allows you to access the sub-menus and adjust the settings.

❿ Channel +/- Buttons

- Allows you to select channels in ascending or descending order.
- Allows you to select the next item in the menu.

⓫ Menu Button

Display the main menu. Also exits menu from screen.



FUNCTION OF TV CONTROLS

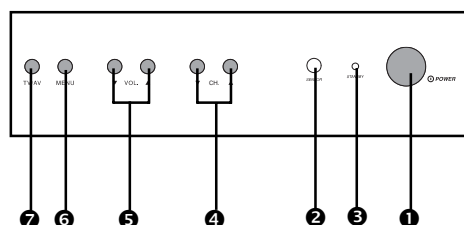
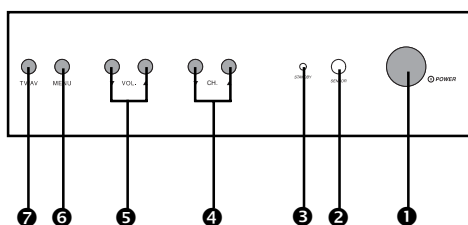

①	Mains Power button	Switch mains power on or off
②	Remote Sensor	Acts as a sensor for activating the controls of the TV when remote control handset is aimed at it.
③	Standby light indicator	Indicate red light when standby mode is activated.
④	Channel down/up button	<ul style="list-style-type: none"> Select channel in descending/ascending order. Turn on the TV when it is in standby mode. Select the next item on the menu.
⑤	Volume down/up button	<ul style="list-style-type: none"> Adjust sound volume softer/louder. Access sub-menu and adjusting the settings.
⑥	Menu button	<ul style="list-style-type: none"> Enter the main menu.
⑦	TV/AV button	<ul style="list-style-type: none"> Switch between TV channel and AV input sources. Turn on the TV when it is in standby mode.



SELECTING THE MAIN MENU

Operating instructions generally explains the operation of the TV set using the buttons on the remote control unless otherwise stated. Please read the following instructions carefully and follow the steps as shown to familiarise yourself with the installations and all features available in your set.

Press the Menu button repeatedly to select the main menu PICTURE, MEMORY and SYSTEM.

Step	Press button		Result on screen
1	MENU	Press once to enter PICTURE main menu.	<div>PICTURE ▶ COLOR 50 BRIGHT 50 CONT 100 SHARP 50 SELECT↑↓ ADJUST←→</div>
2	MENU	Press twice to enter MEMORY main menu.	<div>MEMORY ▶ AUTO SEARCH MANUAL STORE FINE TUNE SELECT↑↓ CONFIRM←→</div>
3	MENU	Press three times to enter SYSTEM main menu.	<div>SYSTEM ▶ COLOR AUTO SOUND BG LANGUAGE 中文 B.B ON SELECT↑↓ ADJUST←→</div>
4	MENU	Menu exit from screen.	



AUTOMATIC TUNING OF CHANNELS

Automatic tuning of channels allows you to store each programme automatically.

Step	Press button	Result on screen
1	Press twice to enter MEMORY main menu.	<div> MEMORY ► AUTO SEARCH MANUAL STORE FINE TUNE SELECT↑↓ CONFIRM←→ </div>
2	/ Press button repeatedly until AUTO SEARCH is selected.	
3	Start automatic tuning of channels.	
4	Press button to stop tuning. Note: when the tuning is completed, the menu will quit automatically.	<div> 1 AUTO VHFL STOP← </div>

MANUAL TUNING OF CHANNELS

Manual tuning allows you to select your preferred channel number for every available programme.

Step	Press button	Result on screen
1	Press twice to enter MEMORY main menu.	<div> MEMORY ► AUTO SEARCH MANUAL STORE FINE TUNE SELECT↑↓ CONFIRM←→ </div>
2	/ Press button repeatedly until Manual Store is selected.	<div> MEMORY AUTO SEARCH ► MANUAL STORE FINE TUNE SELECT↑↓ CONFIRM←→ </div>



MANUAL TUNING OF CHANNELS

Step	Press button	Result on screen
3		Enter Manual Store menu.
4		Press button to manual tune upward. Searching stops once a transmitting signal is found.
5	/	Select POSITION.
6	/	Change the channel position number.
7	/	Select STORE.
8		Press button to confirm
9		Press button to exit menu from screen or menu will quit after a few seconds without further action.

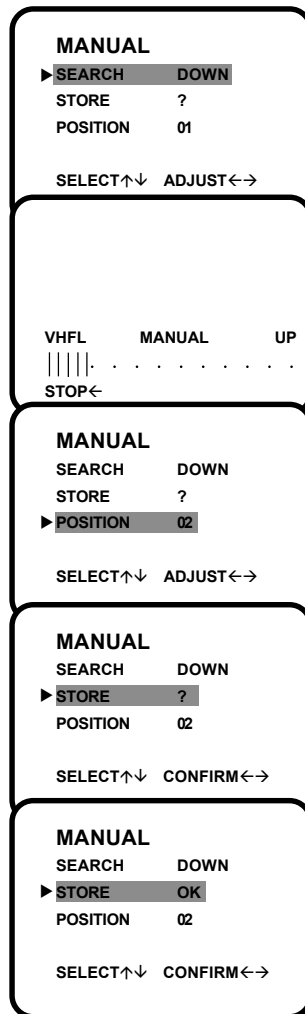

Notes:

- When a channel is found, it can be stored into any channel position number as your desired.
- Manual searching direction can be both upward or downward. This can be chosen by pressing the VOLUME or VOLUME button to start the searching.
- To stop manual tuning, press VOLUME button when searching upward, or press VOLUME button when searching downward.



FINE TUNING of CHANNELS

This feature allows you to adjust picture reception in areas of weak reception.

Step	Press button		Result on screen
1		Press twice to enter MEMORY main menu.	
2		Press button repeatedly until Fine Tune is selected.	
3		Fine tune the channel upward.	
4		Fine tune the channel downward.	
5		Press button to exit menu from screen or menu will quit after a few seconds without further action.	



SELECTING THE COLOUR/SOUND SYSTEM

This feature allows you to select your desired **Colour** and **Sound** system. If Auto is selected, the respective colour system will be automatically selected according to the transmission system. **Note:** Select your desired colour system manually if reception is poor at **Auto** mode.

Step	Press button		Result on screen
1	MENU	Press three times to enter SYSTEM main menu.	<div>SYSTEM ▶ COLOR AUTO SOUND BG LANGUAGE 中文 B.B ON SELECT↕ ADJUST↔</div>
2	⏮ / ⏭	Press button repeatedly until COLOR is selected.	<div>SYSTEM ▶ COLOR PAL SOUND BG LANGUAGE 中文 B.B ON SELECT↕ ADJUST↔</div>
3	⏮ / ⏭	Select the desired colour system (AUTO, PAL, SECAM, NTSC4.43 or NTSC3.58).	<div>SYSTEM COLOR PAL ▶ SOUND BG LANGUAGE 中文 B.B ON SELECT↕ ADJUST↔</div>
4	⏮ / ⏭	Proceed to select SOUND.	<div>SYSTEM COLOR PAL ▶ SOUND DK LANGUAGE 中文 B.B ON SELECT↕ ADJUST↔</div>
5	⏮ / ⏭	Select the desired sound system (BG or DK).	
6	MENU	Press button to exit menu from screen or menu will quit after a few seconds without further action.	

Note : the above procedures are also applicable to the following functions:

- B.B (blue backgroud): sets this function on or off. When B.B is selected to ON mode, it will display a solid blue screen when a channel is selected that has no signal.
- LANGUAGE selection: you can select Chinese or English OSD.



ADJUSTING THE TV PICTURE

This picture menu allows you to make adjustments to the picture.

Step	Press button		Result on screen
1		Press once to enter PICTURE main menu.	
2		Select item.	
3		Adjust level or select desired setting.	
4		Press button to exit menu from screen or menu will quit after a few seconds without further action.	

Picture menu items	Activities
COLOR	Increase or decrease colour level.
BRIGHT	Increase or decrease brightness level.
CONT	Increase or decrease contrast level.
SHARP	Increase or decrease sharpness level to improve detail in picture.
TINT(for NTSC only)	Increase or decrease tint of NTSC picture.



SMART PICTURE CONTROL

Whether you are watching a movie or video game, your TV has automatic video control settings matched to your current program source or content. The Smart Picture feature quickly resets your TV's video controls of program for a number of different types of programs and viewing conditions you may have in your home. Each Smart Picture setting is preset at the factory to automatically adjust the TV's Brightness, Colour, Picture and Sharpness levels.

Step

Press button



NORMAL



Press button repeatedly to cycle through the 4 settings namely, MEMORY, DYNAMIC, STANDARD & MILD and select your desired picture setting.

Definition of Picture settings

MEMORY : picture settings are set to your preference.

DYNAMIC : Emphasize very vibrant colours. This setting is the optimal setting when you are viewing TV programmes in a brightly-lit room.

STANDARD : Emphasize original colours.

MILD : Emphasize "warm" colours. (Suitable for dimly-lit room condition and gives cinema-like effect when light is switched off).

MEMORY

DYNAMIC

STANDARD

MILD



SPECIFICATION

	14PT2010	21PT2010
Picture tube screen size (diagonal)	37cm	54cm
Audio Output: speaker	2 x 2W	2 x 4W
Set Dimension Width Depth Height	331 441 367	600 456 372
Net weight of Set (approximate)	10kg	21kg
TV system	PAL BG PAL DK SECAM BG SECAM DK	
Playback System	NTSC3.58, NTSC4.43	

Note

For Operating Voltage, Frequency, Power Consumption, refer to the type number at the rear of the set.